



Bath chair Installing Instruction

Badewannensitz
Siège de bain
Asiento bañera
Seient banyera



Please read the instruction and keep it well before installing

Structure sketch map (Picture 1):

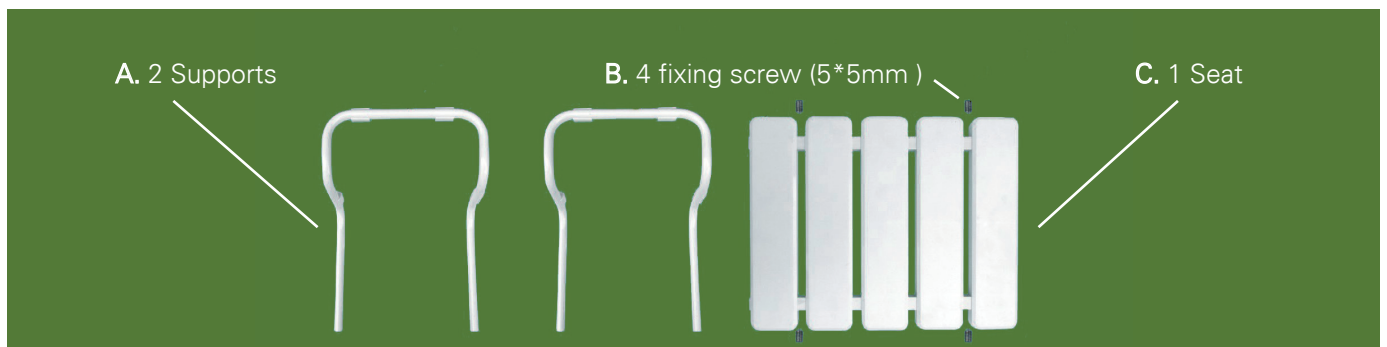

Installing steps (Picture 2):

1. Take all parts out of the inner package and adjust the placket width of support (A) properly, then, insert the ports of support respectively into the holes on left and right of seat (C) and according to the internal width of bathtub, adjust the total length of product so as to match the internal width of bathtub. The adjustable range for the width of bathtub seat is from 50 cm to 65 cm.

2. Tighten for pcs of 5*5 mm (B) fixing screw attached with seat (C), then, the installation is accomplished and set it on the the bathtub for use.

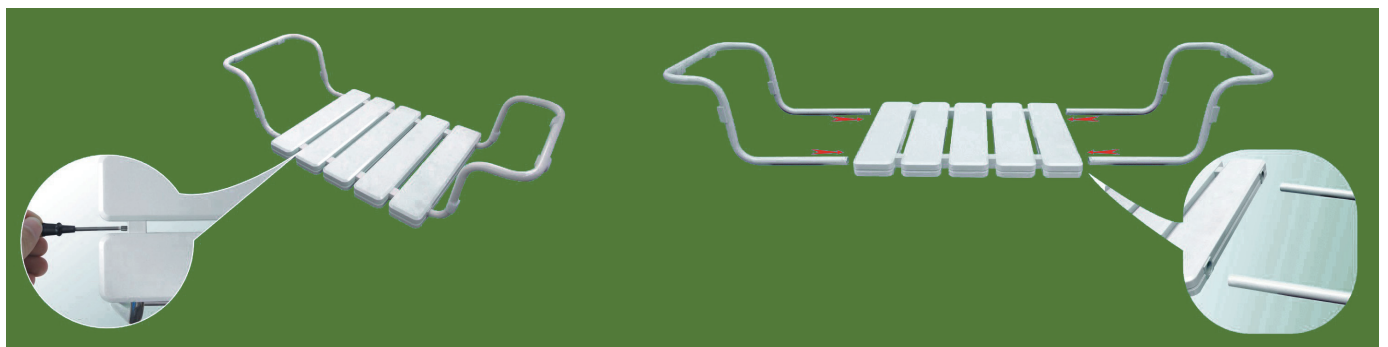

Partial spec. (Picture 3):

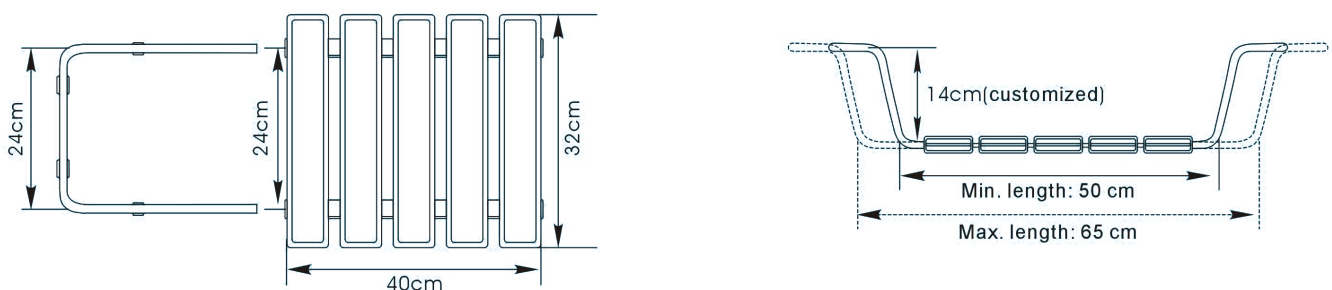

Notice: 1. The safe working load is 120 kg. 2.If the content on instruction is not complied with the real product, please regard the product as reference.